



Schuykill Economic Development Corporation

**Available**

**7.97 acres**

**54,000 sf Building Pad  
Zoned Industrial**

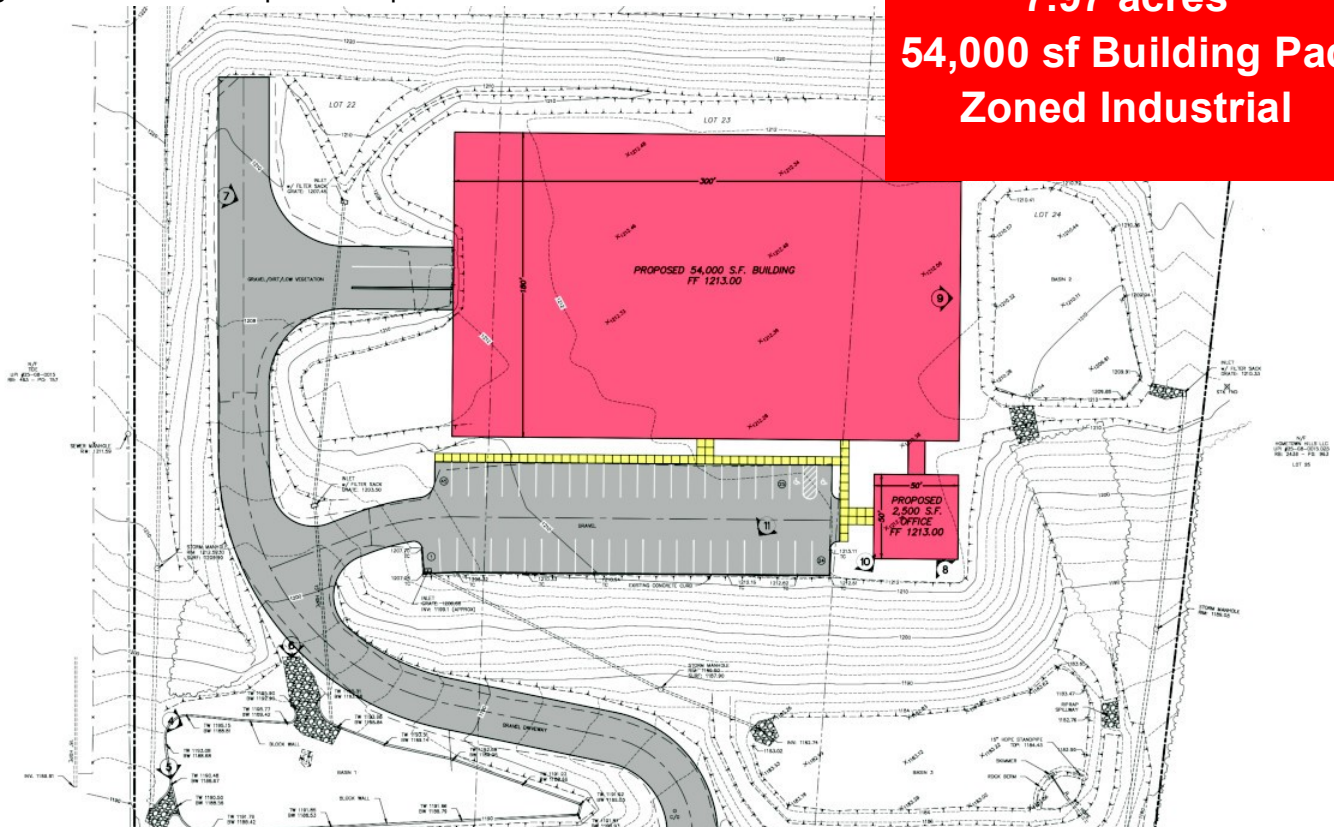

Approved pad-ready site located in Rush Township Industrial Park

Located alongside PA Route 309  
Easy connect to I-81 exits 131, 134 and 138

Ready access to northeast markets

**Lot 22-24 Progress Avenue  
Hometown, PA 18252**

**Site Information**

- Lot Area: 7.97 acres
- County: Schuylkill
- Municipality: Rush Township
- Zoning: Industrial
- Electric: PPL
- Water: Tamaqua Borough Water Authority
- Sewer: Rush Township Sewer Authority

For more information:  
 Frank Zukas, President  
**SEDCO**  
 570-622-1943  
 www.sed-co.com